



44 Spinney Walk, Barnham
West Sussex, PO22 0HT

PEGASUS
PROPERTIES

44 Spinney Walk, Barnham

A beautifully presented detached bungalow, located in an enviable position within striking distance of the bustling village centre, with its eclectic mix of shops, restaurants and railway station, which is direct to London Victoria. The accommodation comprises three good size bedrooms, open plan sitting/dining room, a well-appointed kitchen, family bathroom and attached garage. To the front is a driveway for two cars and an enclosed landscaped garden. The large secluded rear garden is a particular feature. This attractive space boasts extensive lawns, a range of mature trees and borders and backs onto woodland.

- Secluded position
- 3 bedrooms
- Open plan sitting/dining room
- Parking for 2 cars
- Attached garage
- Well presented
- Beautiful rear gardens
- Backing onto woodland





Services

Water, gas, electricity and mains drainage are connected.
Please note that none of the services or appliances have been tested by Pegasus.

Council Tax

Arun District Council Tax: Band D

Viewings by appointment only

Please contact Pegasus on 01243 940940 or call into our office to arrange a viewing of this property.

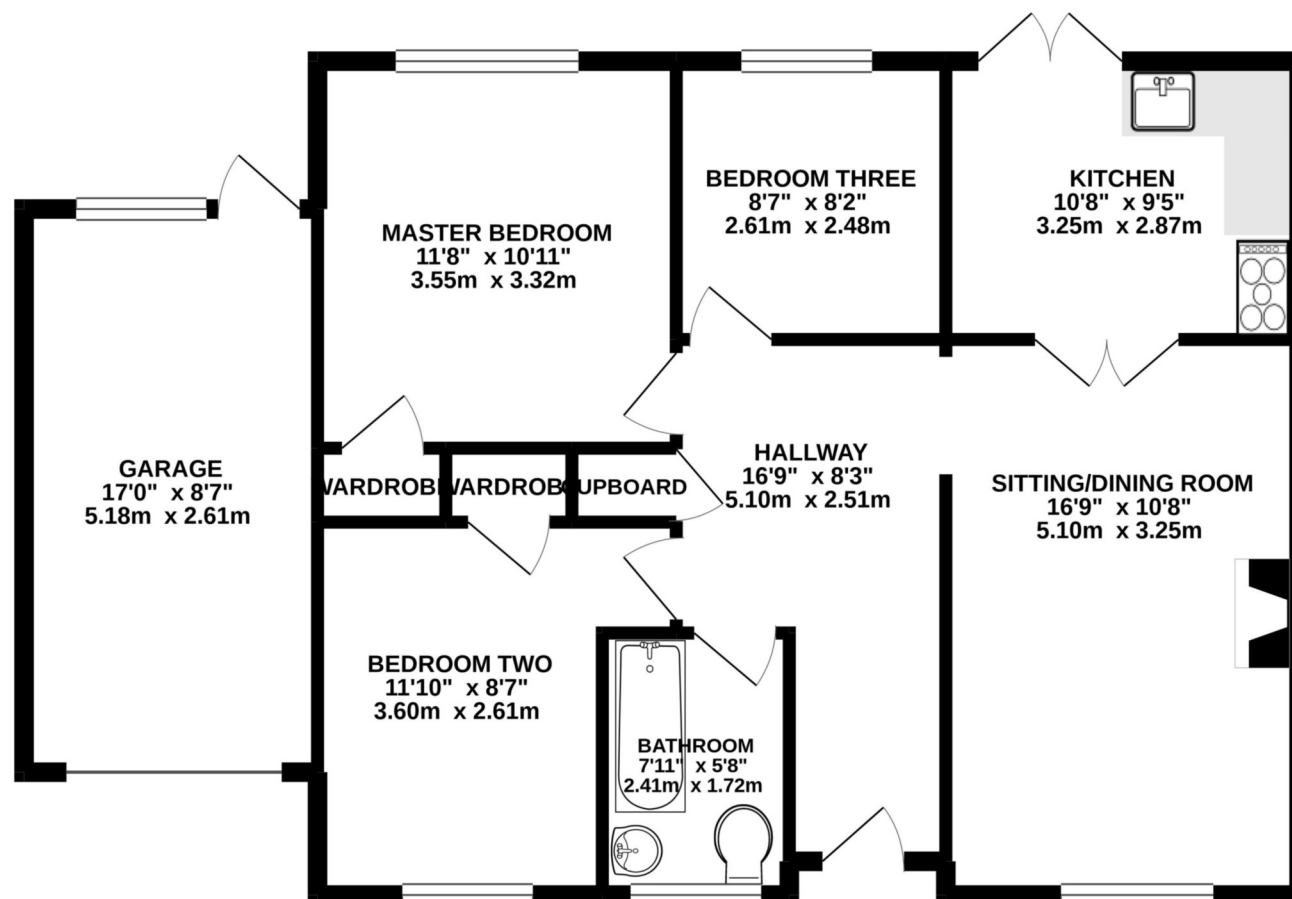

TOTAL FLOOR AREA : 886 sq.ft. (82.3 sq.m.) approx.

Whilst every attempt has been made to ensure the accuracy of the floorplan contained here, measurements of doors, windows, rooms and any other items are approximate and no responsibility is taken for any error, omission or mis-statement. This plan is for illustrative purposes only and should be used as such by any prospective purchaser. The services, systems and appliances shown have not been tested and no guarantee as to their operability or efficiency can be given.

Pegasus Properties

39 Barnham Road, Barnham, West Sussex PO22 0ER

01243 940940 barnham@pegasusproperties.co.uk pegasusproperties.co.uk

